



4 * Radisson Blu Royal Hotel,
Dublin City Centre

- Renovation of ground floor outlets, lobby and lounge
- Additional 84 bedrooms to increase our bed stock up to **234 rooms**
Extension of our 7th Floor Sky Suite which will see the capacity increase from 50 to 120 pax (*Coming Soon*)
- **Fitness/Gym** facilities on-site
- New **Spa** facilities with 6 treatment rooms, sauna, steam and hydrotherapy pool
- **Convention Centre** for up to **800 delegates** theatre or **540 banquet style** (*Coming soon, quarter 3 2022*)
- **Heritage Garden** / Le Pole Square preservation site/feature
(*Coming soon, quarter 3-4 2022*)

CALL +353 1 8982900 OR EMAIL INFO@MEETINGSINDUBLIN.COM

WWW.DUBLINROYALCONVENTIONCENTRE.COM



Radisson BLU

ROYAL HOTEL, DUBLIN



CALL +353 1 8982900 OR EMAIL INFO@MEETINGSINDUBLIN.COM
WWW.DUBLINROYALCONVENTIONCENTRE.COM



DUBLIN ROYAL CONVENTION CENTRE

CALL 01 8982900 OR EMAIL INFO@MEETINGSINDUBLIN.COM

WWW.DUBLINROYALCONVENTIONCENTRE.COM

Location - Dublin's Integrated Transport

The site is in close proximity of all major transport links within the City, including LUAS, Bus, Dart and city bike locations

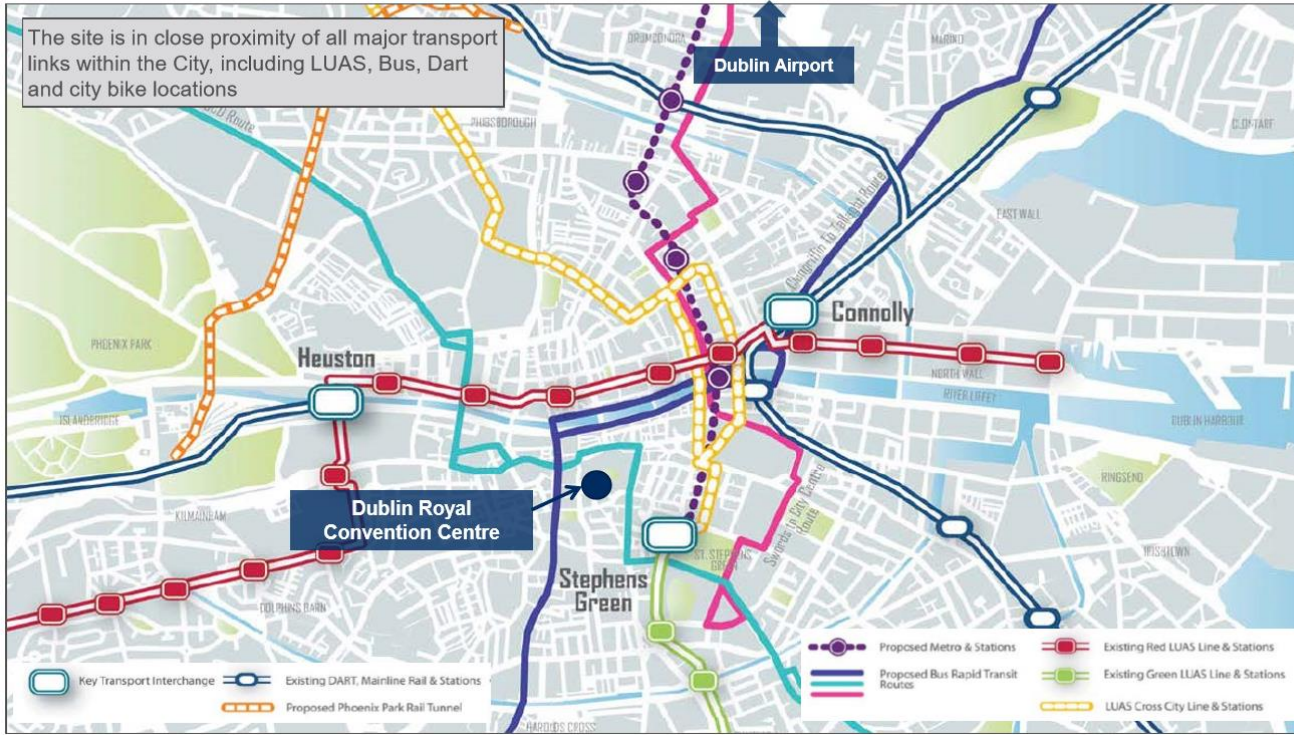

DUBLIN ROYAL CONVENTION CENTRE

CALL +353 1 8982900 OR EMAIL INFO@MEETINGSINDUBLIN.COM

WWW.DUBLINROYALCONVENTIONCENTRE.COM

Location - Dublin's Historic Core

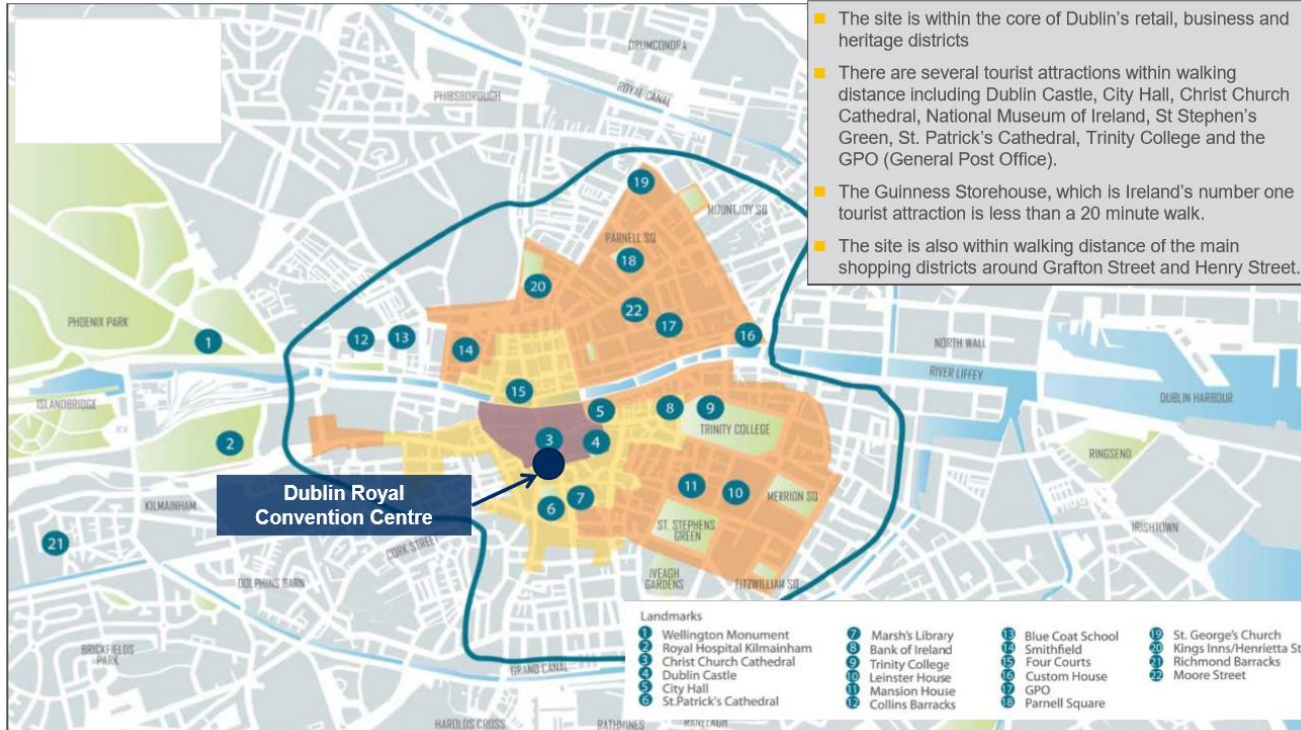

- The site is within the core of Dublin's retail, business and heritage districts
- There are several tourist attractions within walking distance including Dublin Castle, City Hall, Christ Church Cathedral, National Museum of Ireland, St Stephen's Green, St. Patrick's Cathedral, Trinity College and the GPO (General Post Office).
- The Guinness Storehouse, which is Ireland's number one tourist attraction is less than a 20 minute walk.
- The site is also within walking distance of the main shopping districts around Grafton Street and Henry Street.



**DUBLIN ROYAL
CONVENTION CENTRE**

CALL +353 1 8982900 OR EMAIL INFO@MEETINGSINDUBLIN.COM

WWW.DUBLINROYALCONVENTIONCENTRE.COM

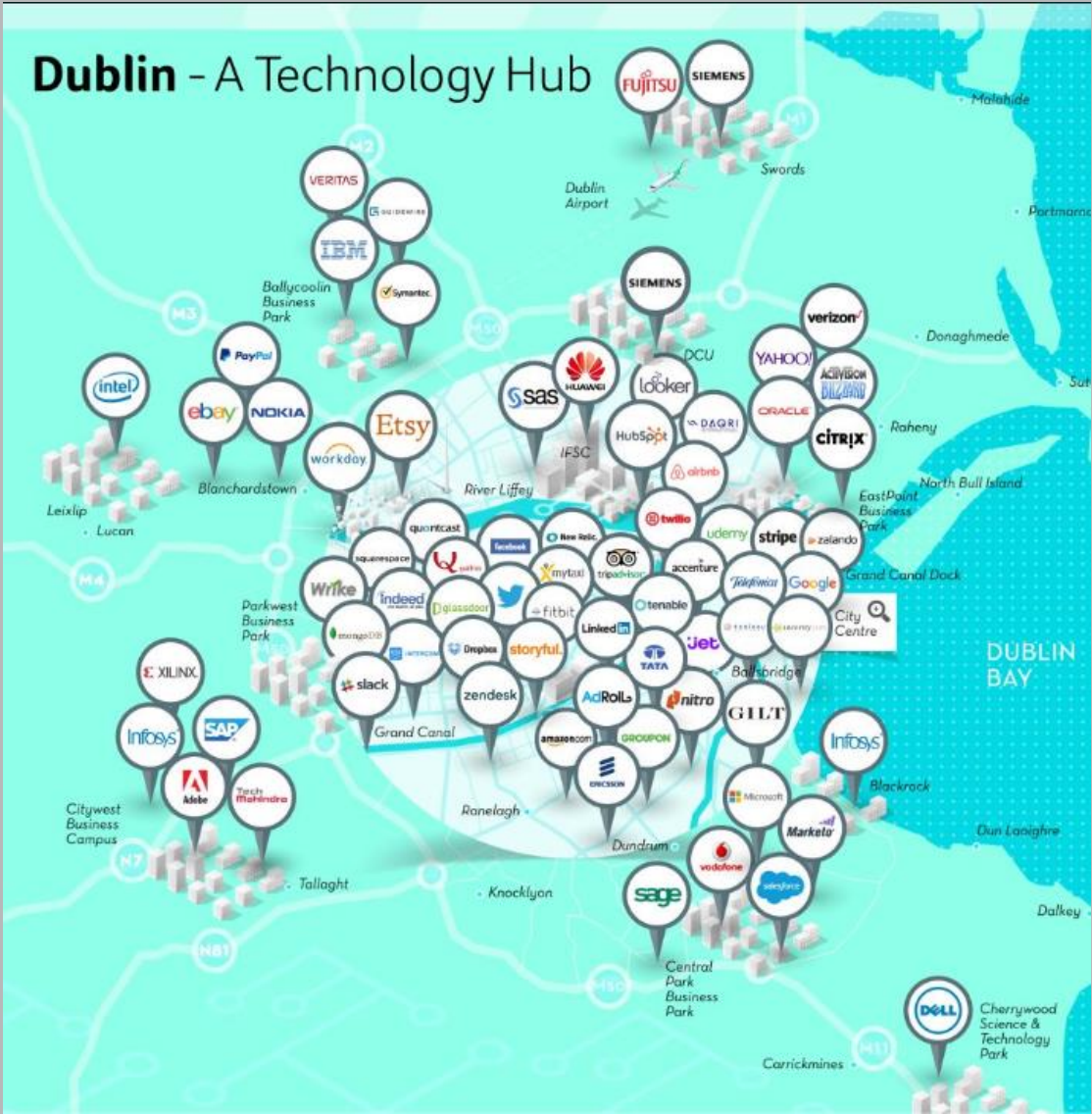

**DUBLIN ROYAL
CONVENTION CENTRE**

CALL +353 1 8982900 OR EMAIL INFO@MEETINGSINDUBLIN.COM
WWW.DUBLINROYALCONVENTIONCENTRE.COM

Convention Centre
(Estimated opening Q3 2022)







Higgins Suite



Robinson Suite



DUBLIN ROYAL CONVENTION CENTRE

Capabilities - Offering 5 professionally designed meeting spaces over 985m², accommodating up to 800 delegates

Main Plenary – 744 sq. metres which can be split into two sections with a spacious pre-conference area (446 sq. metres) outside the room. All located on the ground floor level.

Break-out room 1&2 – 113 sq. metres which can be split into two sections. Located on the first floor.

Break-out room 3&4 – 130 sq. metres which can be split into two sections. Located on the first floor.

Pre-conference lobby – 202 sq. metres
Bar & Ground floor area – 187 sq. metres
Pre-conference area – 57 sq. metres
(TOTAL: 446 sq. metres)



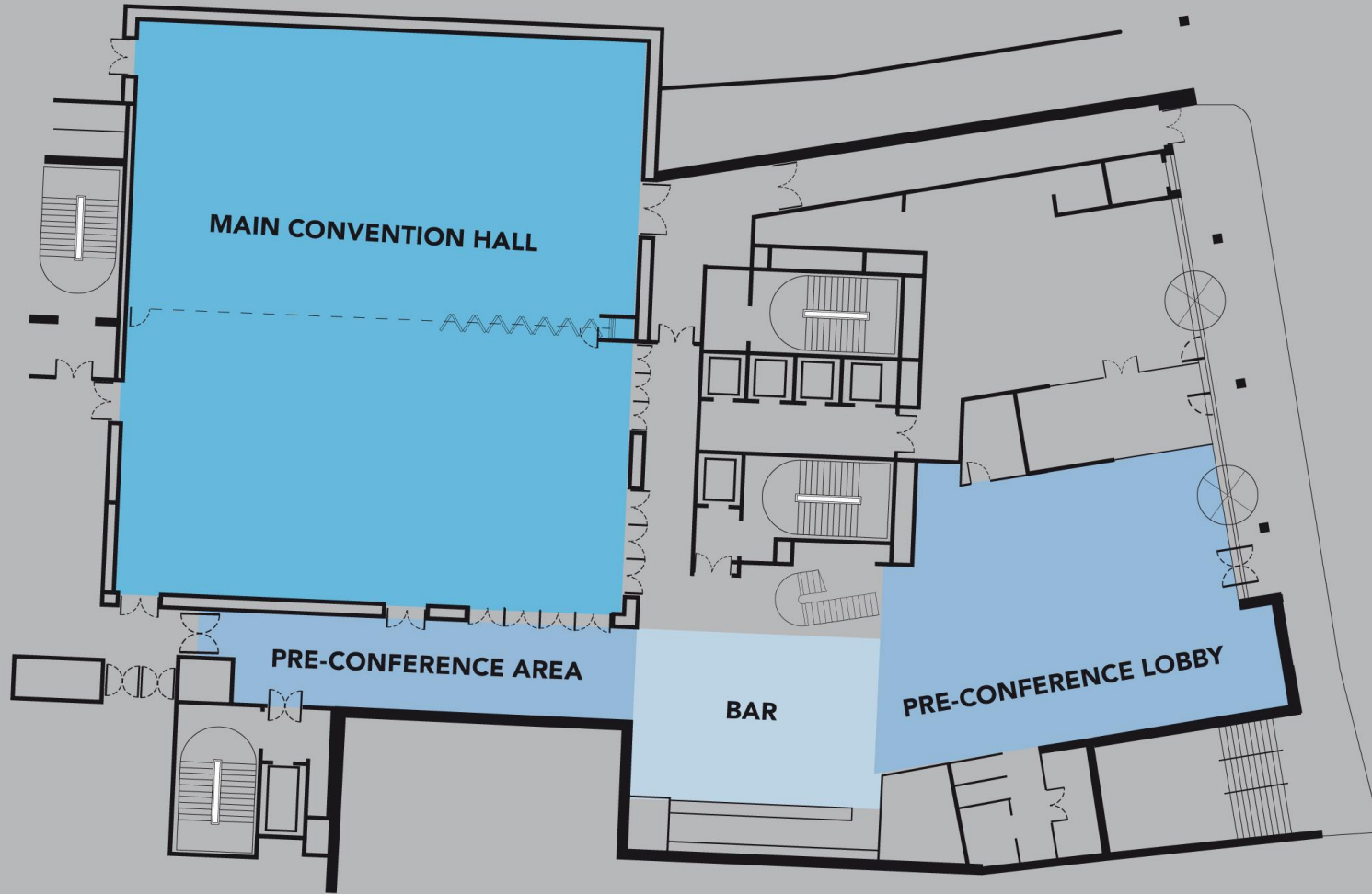

CAPACITY CHART

MAIN CONVENTION HALL 744^{M2}

Theatre Style 800

Classroom Style 400

Cabaret Style 378

Banquet Style 540

PRE CONFERENCE AREA 57^{M2}

MAIN BAR AREA 187^{M2}

PRE CONFERENCE LOBBY 202^{M2}



**DUBLIN ROYAL
CONVENTION CENTRE**

CALL +353 1 8982900 OR EMAIL INFO@MEETINGSINDUBLIN.COM

WWW.DUBLINROYALCONVENTIONCENTRE.COM

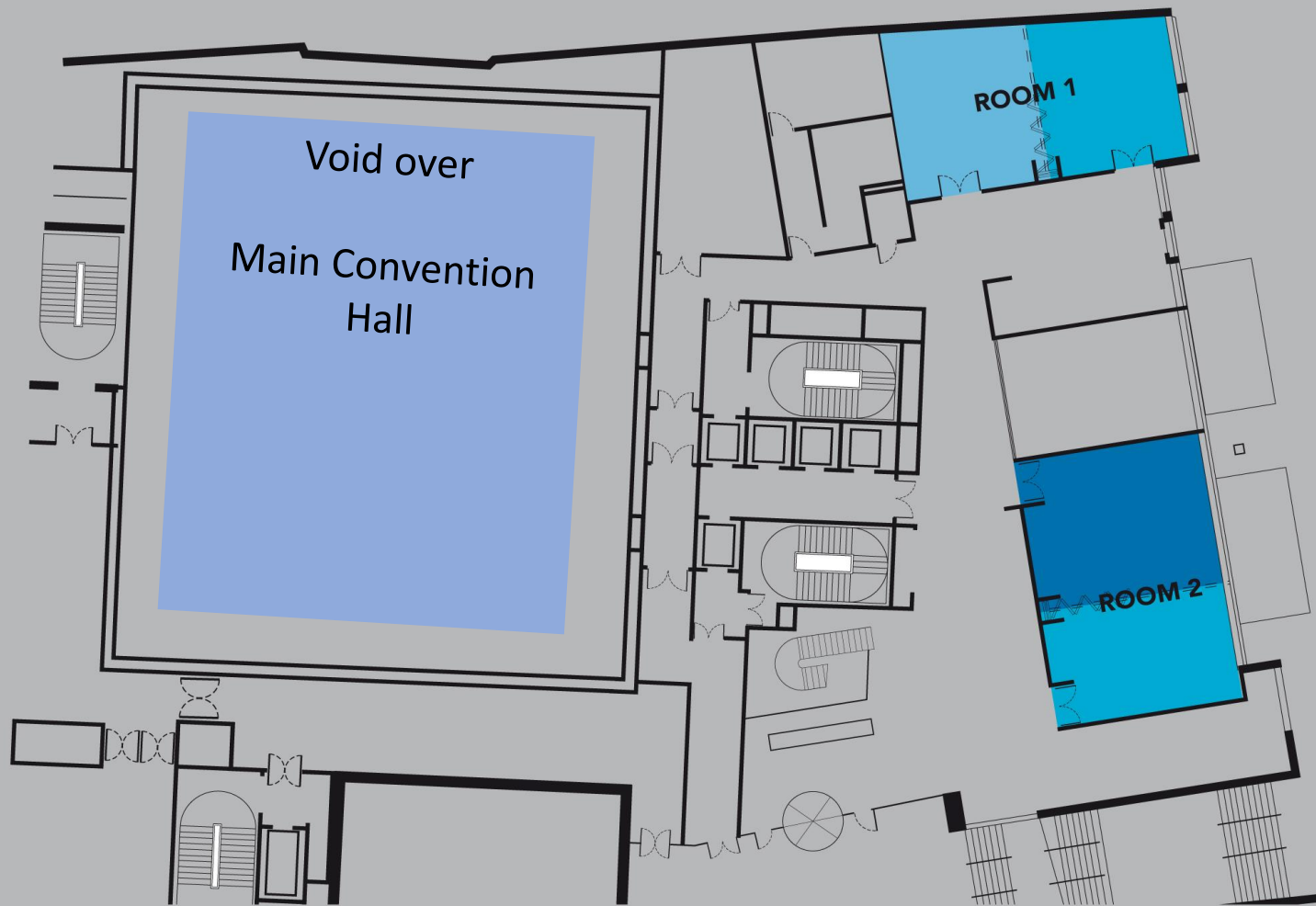

CAPACITY CHART

FIRST FLOOR ROOM 1 130^{M2}

Theatre Style	160
Classroom Style	90
Cabaret Style	70
Banquet Style	100

FIRST FLOOR ROOM 2 113^{M2}

Theatre Style	110
Classroom Style	72
Cabaret Style	42
Banquet Style	80



DUBLIN ROYAL
CONVENTION CENTRE

CALL +353 1 8982900 OR EMAIL INFO@MEETINGSINDUBLIN.COM

WWW.DUBLINROYALCONVENTIONCENTRE.COM

Key Facts:

Location – Ship Street Great, Dublin 8 , Ireland

Longitude; -6.268317103385926 **Latitude;** 53.34197679300878

Capabilities - Offering 5 professionally designed meeting spaces over 985m², accommodating up to 800 delegates

Main Plenary – 744 sq. metres which can be split into two sections with a spacious pre-conference area (446 sq. metres) outside the room. All located on the ground floor level.

Break-out room 1&2 – 113 sq. metres which can be split into two sections. Located on the first floor.

Break-out room 3&4– 130 sq. metres which can be split into two sections. Located on the first floor.

Pre-conference lobby – 202 sq. metres

Bar & Ground floor area – 187 sq. metres

Pre-conference area – 57 sq. metres

(TOTAL: 446 sq metres)

CALL +353 1 8982900 OR EMAIL INFO@MEETINGSINDUBLIN.COM

WWW.DUBLINROYALCONVENTIONCENTRE.COM



**DUBLIN ROYAL
CONVENTION CENTRE**



CALL +353 1 8982900 OR EMAIL INFO@MEETINGSINDUBLIN.COM

WWW.DUBLINROYALCONVENTIONCENTRE.COM



CALL +353 1 8982900 OR EMAIL INFO@MEETINGSINDUBLIN.COM

WWW.DUBLINROYALCONVENTIONCENTRE.COM



Thank you for your attention and we look forward to welcoming your clients to Dublin.

Keep in touch;

Melissa.ogrady@radissonblu.com

Direct: +353 1 898 2979

Mobile: +353 86 792 8597

CALL +353 1 8982900 OR EMAIL INFO@MEETINGSINDUBLIN.COM

WWW.DUBLINROYALCONVENTIONCENTRE.COM

